

# WASHDOWN DUTY STAINLESS STEEL 3-PHASE AC MOTORS

**NEW**

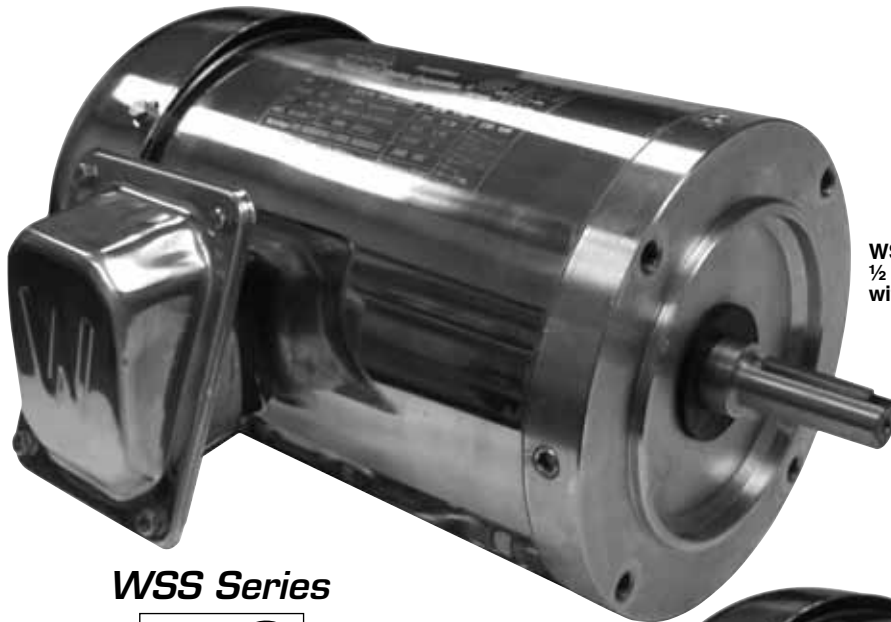

WSS12-18-56CRD,  
½ HP SS motor  
without base.

Both models shown  
smaller than actual size.

## WSS Series



- ⅓ to 2 HP, 3600 and 1800 RPM
- 208 to 230/460 Volt
- TEFC Enclosure
- 1.15 Service Factor
- Class F Insulation
- C-Face—Rigid Base and Round Body
- Double Lip Seals on Both Ends of the Motor with an Additional Shaft Slinger on the Drive-End
- O-Rings Installed on Endbells to Eliminate Moisture
- Pre-Installed Watertight, Stainless Cord Connector
- Inverter Duty
- Suitable for 50 Hz Operation with 1.0 Service Factor

The WSS Series stainless steel motors are 3-phase industrial grade washdown duty motors made with 300 grade stainless steel housing, in sizes from ⅓ to 2 H.P. These motors are available with a double reinforced welded 56H base or without a base in the round body style. All motors are constructed with the windings double dipped and cured

in polyester insulating varnish, anti-rust coated rotor to protect against corrosion, double-lip seals plus V-ring shaft slingers. All motors have laser-etched full-fact name plates and a watertight stainless cord connector pre-installed in the split designed conduit box.

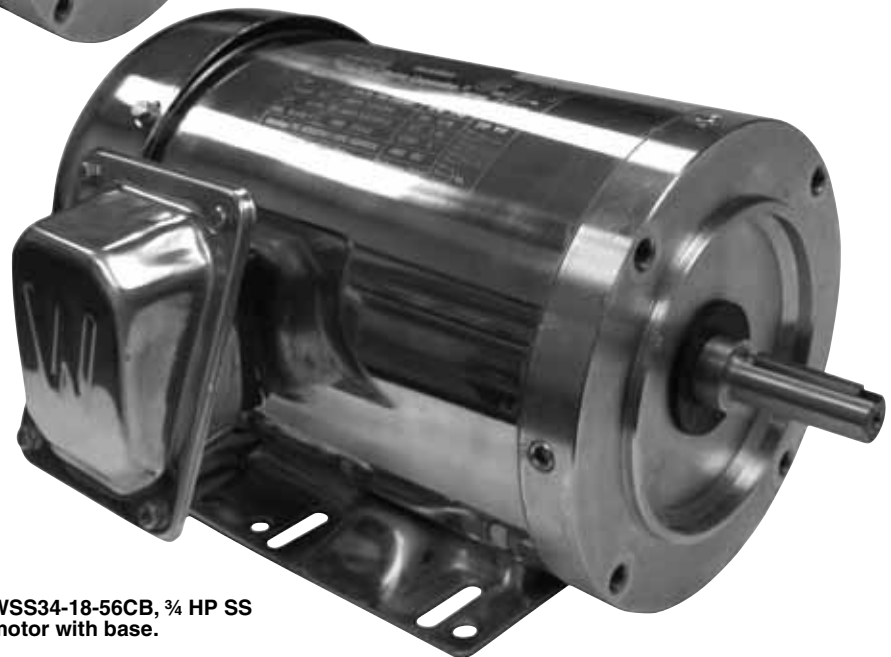

WSS34-18-56CB, ¾ HP SS  
motor with base.

## SPECIFICATIONS

**Voltage:** 230/460V, 3 phase 60 Hz—can run on 50 Hz with reduced service factor of 1.0

**Frame/Enclosure:** 56C/TEFC, 300 grade stainless steel

**Rated Speed:** 1725/3460

**Duty Cycle:** Continuous

**Base Type:** C-face—rigid

**Shaft:** Keyed, 304 Stainless Steel

**Bearings:** 6205 DDU

**Rotation:** CW/CCW

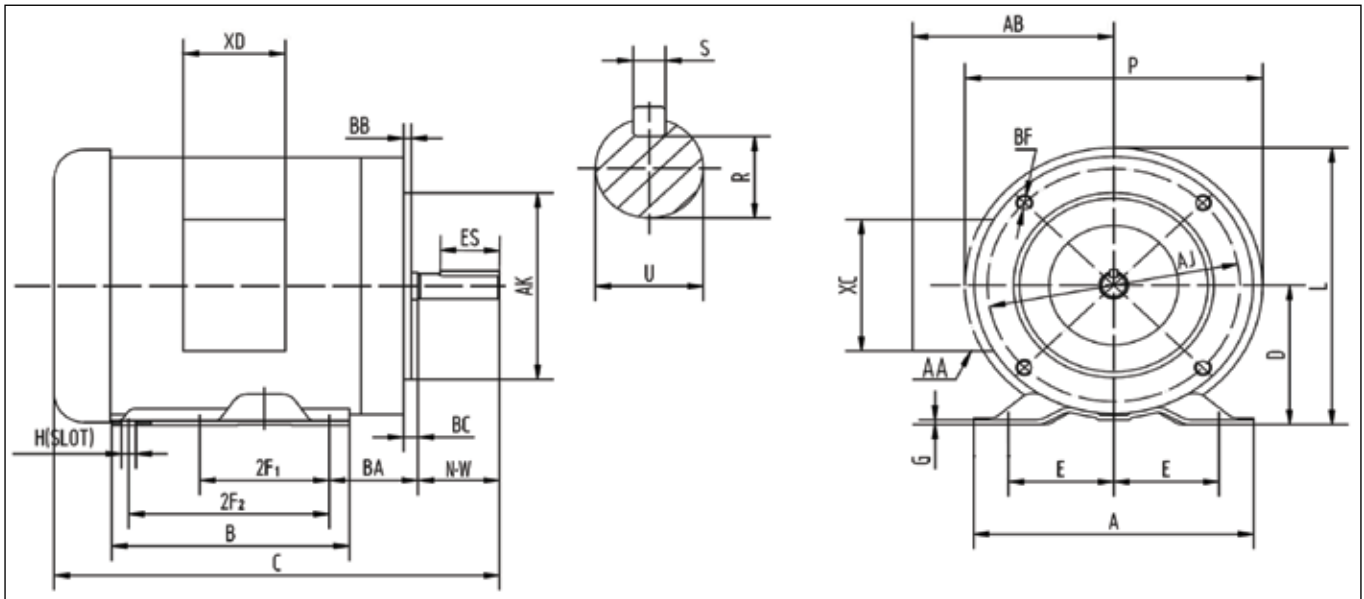

**DIMENSIONS: mm (inch)**

mm (inch)	MOUNTING					A	B	C	D	G	P	AA	AB
	E	2F1	2F2	H	BA								
62 (2.44)	76.2 (3)	127 (5)	8.64 (0.34)	69.9 (2.75)	165 (6.5)	165 (6.5)	*See note	88.9 (3.5)	3 (0.12)	216 (8.5)	21.8 (0.86)	146 (5.75)	

mm (inch)	BC	KEY		KEYSEAT		FLANGE			SHAFT		TERMINAL BOX	
		ES	S	R	AJ	AK	BB	BF	N-W	U	XC	XD
4.83 (0.19)	35.8 (1.41)	4.78 (0.188)	13.13 (0.517)	149 (5.875)	114 (4.5)	4.06 (0.16)	— ( $\frac{3}{16}$ -16)	47.8 (1.88)	15.9 (0.625)	83 (3.27)	96.5 (3.8)	

\* **Note:** C = 294 mm (11.59") for 1/3 to 1/2 H.P., C = 319 mm (12.57") for 3/4 to 3 H.P.

**To Order Visit [omega.com/wss\\_series](http://omega.com/wss_series) for Pricing and Details**

MODEL NUMBER	HP	RPM	FULL LOAD AMPS @		RATED TORQUE (lb. ft.)	WEIGHT
			208 to 230 V	460 V		
<b>MOTORS WITH BASE</b>						
WSS13-18-56CB	1/3	1800	1.4	0.7	1.0	28
WSS12-36-56CB	1/2	3600	1.8	0.9	0.7	29
WSS12-18-56CB	1/2	1800	1.5	0.75	1.5	31
WSS34-36-56CB	3/4	3600	2.3	1.15	1.1	33
WSS34-18-56CB	3/4	1800	2.4	1.2	2.2	33
WSS1-36-56CB	1	3600	3	1.5	1.5	35
WSS1-18-56CB	1	1800	3.2	1.6	3	36
WSS1.5-36-56CB	1.5	3600	4	2	2.2	39
WSS1.5-18-56CB	1.5	1800	4.2	2.1	4.4	42
WSS2-36-56CB	2	3600	4.8	2.4	2.9	45
WSS2-18-56CB	2	1800	6	3	5.9	51
<b>ROUND BODY MOTORS</b>						
WSS13-18-56CRD	1/3	1800	1.4	0.7	1	28
WSS12-18-56CRD	1/2	1800	1.5	0.75	1.5	31
WSS34-18-56CRD	3/4	1800	2.4	1.2	2.2	33
WSS1-18-56CRD	1	1800	3.2	1.6	3	36
WSS1.5-18-56CRD	1.5	1800	4.2	2.1	4.4	42
WSS2-18-56CRD	2	1800	6	3	5.9	51

**Ordering Examples:** WSS13-18-56C, stainless steel washdown duty 3-phase motor with base, 1/3 HP, 1800 RPM, 0.7 Amps @ 460 V, rated torque 1 lb.ft.  
WSS1-18-56CRD, stainless steel washdown duty 3-phase round body motor without base, 1 HP, 1800 RPM, 1.6 Amps @ 460 V, rated torque 3 lb.ft.