

# Wireless Transceiver with Modbus Interface

OMWT-XREC-MOD

Starts at

**\$400**



- ✓ **RS-485 Master/Slave Auto-Sensing Radio Interface**
- ✓ **Receives Data from OMWT-REP-900 Wireless Repeater**
- ✓ **Provides Remote Capability to RS-485 Modbus Networks**
- ✓ **Built-in 900 MHz Frequency Hopping Radio for Long-Range Wireless Interface**
- ✓ **Multiple Radios Allow Many Remote RS-485 Networks to Coexist Logically**

OMWT-XREC-MOD, \$400, shown smaller than actual size.



The OMWT-XREC-MOD Wireless Transceiver uses an embedded 100-milliwatt frequency hopping wireless modem that provides communication between a local RS-485 network and a remote network of RS-485 connected devices. The OMWT-XREC-MOD will automatically sense the direction of data flow and switch the RS-485 and radio devices accordingly. The OMWT-XREC-MOD can be placed in a network of RS-485 devices and appear as a slave repeater of remote RS-485 devices or it can be placed in a network of one or many RS-485 slaves and act as the RS-485 repeater of a remote master. The radio operates within the 900 MHz ISM Band under Part 15 of the FCC Rules and regulations.

The OMWT-XREC-MOD operates at 19200 Baud at either odd parity or no parity. Dip switches select parity and one of 7 radio networks. Radios operating together must have the same radio network address (1-7 set by switches labeled A0-A2). Select a different radio network address to prevent interference from nearby networks that are not sharing information. The default radio network for roof-top applications is 5. The user may choose another network address (1-7) if desired. While all radios in a network must have the same network address they do not have to have the same parity; the parity is local to the RS-485 serial port on the OMWT-XREC-MOD only. Parity information is not transmitted or received.

Radio network selection 0 (A0, A1, A2 all set to 0) selects a special network setup. When network address setting 0 is selected the pre-programmed radio network parameters are used; these parameters are user and application specific and must be set at the factory for specific applications.

The OMWT-XREC-MOD can also be used as a general purpose RS-485 half duplex radio interface operating at 19200 baud at either odd or no parity (dip switch selectable).

The OMWT-XREC-MOD is supplied standard with a 1/2 wave monopole antenna. For longer distance outdoor use, optional Omni-Directional and YAGI directional line-of-site antennas are available.

## Specifications

**Frequency Range:** 902 to 928 MHz, unlicensed ISM Band

**Type:** Frequency hopping spread spectrum transceiver

**Frequency Control:** Direct FM

**Transport Protocol:** Transparent networking

**Network Topology:** Multi-drop

**Channel Capacity:** Hops through 25 channels, up to 65,000 NetIDs



## OMWT Series Wireless Transmitters with Modbus Receiver

High Power 900 MHz System with Modbus Receiver

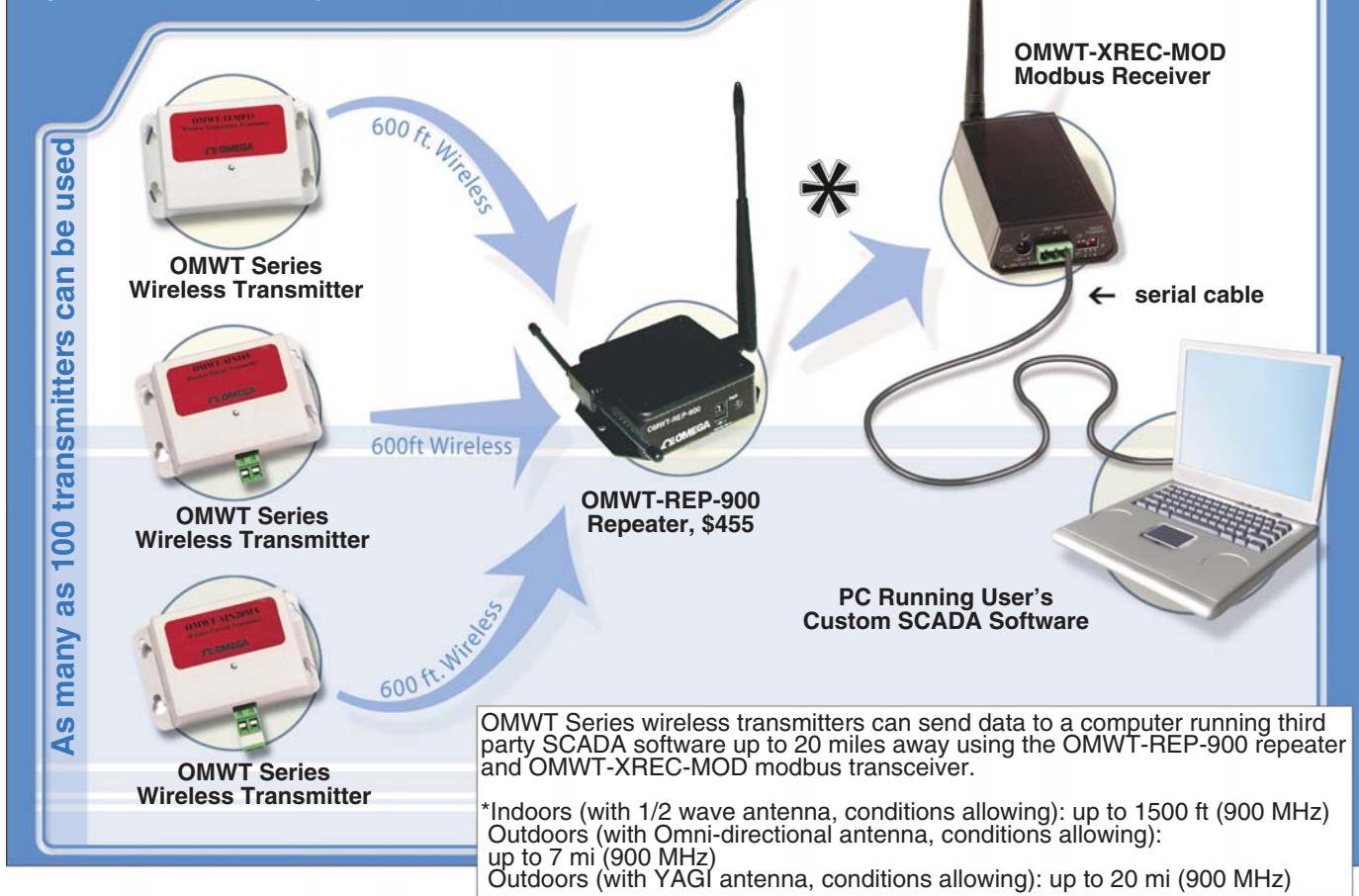

### Serial Data Interface:

Asynchronous (RS-232) CMOS (TTL) signals, 5V, 3.3V tolerant

**I/O Data Rate:** 9600 baud

**Channel Data Rate:**

10K bps at 9600 baud

**Transmit Power Output:** 100mW

**Rx Sensitivity:** -110 or -107 respectively

**Transceiver Range Indoor (with Standard 1/2 Wave Monopole Antenna):** 180 to 450 m (600 to 1500'), 900 MHz;

**Transceiver Range Outdoor (With Optional Omni-Directional Antenna):**

Up to 7 mi (11 km), 900 MHz

**Transceiver Range Outdoor (with Optional YAGI Antenna):**

Up to 20 mi (32 km), 900 MHz

**Interference Rejection:**

70 dB at pager and cellular phone frequencies

**Power:** 5 Vdc  $\pm$ 0.3V, 170 mA nominal transmitting, 50 mA nominal receiving

**Operating Temperature:** 0 to 70°C (32 to 158°F)

**Storage Temperature:** 0 to 70°C (32 to 158°F)

### Operating Humidity:

10 to 90% RH non-condensing

### Dimensions

**(Without Antenna):**

70 x 127 x 35 mm D

(2.75 x 5.00 x 1.375")

**Weight:** 142 g (5 oz)

**AVAILABLE FOR FAST DELIVERY!**

To Order (Specify Model Number)		
Model No.	Price	Description
OMWT-XREC-MOD	\$400	Wireless transceiver with Modbus interface
OMWT-OMNI-900-20	330	900 MHz omni-directional antenna with 6 m (20') cable*
OMWT-YAGI-900-20	330	900 MHz YAGI antenna with 6.1 m (20') cable*

Each wireless transceiver includes 1/2 wave antenna and 110 Vac adaptor.

\* Additional antennas are available. Contact the Data Acquisition Engineering Department.  
**Ordering Example: OMWT-XREC-MOD wireless transceiver with Modbus interface, \$400.**



#### UNITED STATES

[www.omega.com](http://www.omega.com)  
1-800-TC-OMEGA  
Stamford, CT.

#### CANADA

[www.omega.ca](http://www.omega.ca)  
Laval(Quebec)  
1-800-TC-OMEGA

#### GERMANY

[www.omega.de](http://www.omega.de)  
Deckenpfronn, Germany  
0800-8266342

#### UNITED KINGDOM

[www.omega.co.uk](http://www.omega.co.uk)  
Manchester, England  
0800-488-488

#### FRANCE

[www.omega.fr](http://www.omega.fr)  
Guyancourt, France  
088-466-342

#### CZECH REPUBLIC

[www.omegaeng.cz](http://www.omegaeng.cz)  
Karviná, Czech Republic  
596-311-899

#### BENELUX

[www.omega.nl](http://www.omega.nl)  
Amstelveen, NL  
0800-099-33-44



## More than 100,000 Products Available!

### • Temperature

Calibrators, Connectors, General Test and Measurement Instruments, Glass Bulb Thermometers, Handheld Instruments for Temperature Measurement, Ice Point References, Indicating Labels, Crayons, Cements and Lacquers, Infrared Temperature Measurement Instruments, Recorders Relative Humidity Measurement Instruments, RTD Probes, Elements and Assemblies, Temperature & Process Meters, Timers and Counters, Temperature and Process Controllers and Power Switching Devices, Thermistor Elements, Probes and Assemblies, Thermocouples Thermowells and Head and Well Assemblies, Transmitters, Wire

### • Flow and Level

Air Velocity Indicators, Doppler Flowmeters, Level Measurement, Magnetic Flowmeters, Mass Flowmeters, Pitot Tubes, Pumps, Rotameters, Turbine and Paddle Wheel Flowmeters, Ultrasonic Flowmeters, Valves, Variable Area Flowmeters, Vortex Shedding Flowmeters

### • pH and Conductivity

Conductivity Instrumentation, Dissolved Oxygen Instrumentation, Environmental Instrumentation, pH Electrodes and Instruments, Water and Soil Analysis Instrumentation

### • Data Acquisition

Auto-Dialers and Alarm Monitoring Systems, Communication Products and Converters, Data Acquisition and Analysis Software, Data Loggers Plug-in Cards, Signal Conditioners, USB, RS232, RS485 and Parallel Port Data Acquisition Systems, Wireless Transmitters and Receivers

### • Pressure, Strain and Force

Displacement Transducers, Dynamic Measurement Force Sensors, Instrumentation for Pressure and Strain Measurements, Load Cells, Pressure Gauges, Pressure Reference Section, Pressure Switches, Pressure Transducers, Proximity Transducers, Regulators, Strain Gages, Torque Transducers, Valves

### • Heaters

Band Heaters, Cartridge Heaters, Circulation Heaters, Comfort Heaters, Controllers, Meters and Switching Devices, Flexible Heaters, General Test and Measurement Instruments, Heater Hook-up Wire, Heating Cable Systems, Immersion Heaters, Process Air and Duct, Heaters, Radiant Heaters, Strip Heaters, Tubular Heaters