

Flanged Immersion Heaters with Custom Size and Shape Flanges

TPN6 Series

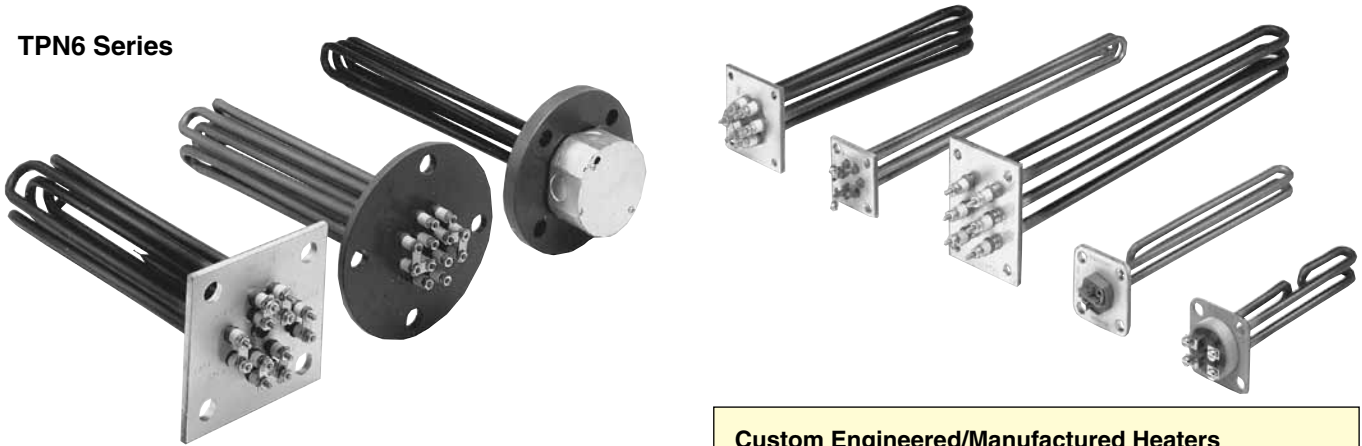

Typical Applications

- Hot Air Dryers
- Dehumidifying Dryers
- Heat Exchange Systems
- Water and Water Solutions
- Steam Tables
- Air Heating

Custom Immersion Heaters

This design consists of tubular heating elements silver brazed or TIG welded to a flange cut from steel or stainless steel plate. Flange plate size, thickness and shape are determined by the application. A fiber gasket is supplied with each heater. This type construction also lends itself to be easily and economically engineered into new equipment.

Custom Engineered/Manufactured Heaters

An electric heater can be very application specific; for sizes and ratings not listed, OMEGA will design and manufacture a flanged immersion heater to meet your requirements.

Please Specify the Following:

- ✓ Wattage, Voltage and Phase
- ✓ Element Immersion Length
- ✓ Flange Size and Material
- ✓ Electrical Enclosure, if required
- ✓ Element Sheath Material
- ✓ Optional Features
- ✓ Element Watt Density

7" Diameter Steel Flange, 3 Incoloy® 800 Elements

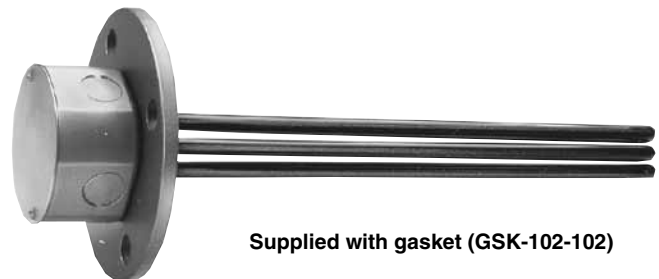
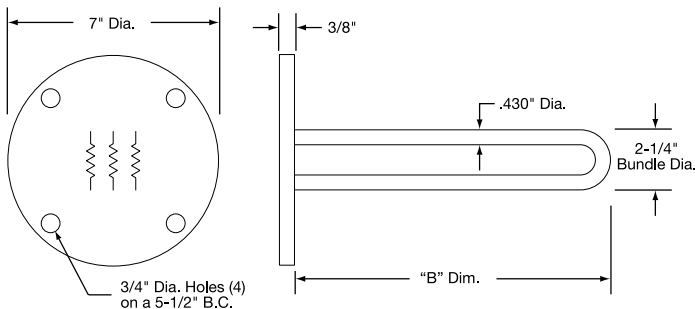

Supplied with gasket (GSK-102-102)

To Order Visit omega.com/tpn6 for Pricing and Details

Model No.				Approx Weight		Element Sheath Material	Watt Density			B	
240V-1Ph	240V-3Ph	480V-1Ph	480V-3Ph	kg	lb		KW	Watt/cm ²	Watt/in ²	mm	inch
TPN01460	TPN01461	TPN01462	TPN01463	2.7	6	Incoloy® 800	3	3.7	24	448	17%
TPN01347	TPN01339	TPN01464	TPN01465	2.3	5		4.5	7.8	50	314	12%
TPN01348	TPN01198	TPN01349	TPN01223	2.7	6		9	10.8	70	454	17%
—	TPN01304	TPN01466	TPN01467	2.7	6		12	10.8	70	581	22%

Ordering Example: TPN01461, 3 KW, 240 Vac, 3 phase flanged immersion heater.