

TRANSDUCER-QUALITY STRAIN GAGES

To Order (Specify Model Number)

TYPE SERIES	MODEL NO.	PRICE PER PKG OF 5	FOIL MATERIAL	TEMP. COEF.*	Ω	DIMENSIONS [MM]				MAX EXC	TERM PADS	
						GRID A	GRID B	CARRIER C	CARRIER D			
LY SERIES UNIAXIAL GAGES ✓ Encapsulated Gages with Solder Pads (Accessory Terminal Pads Are Used for Strain Relief and Connecting Different Gage Wires)	SG-3/350-LY47K	\$89	Karma	SS	350	3.3	1.5	8.2	4.0	10	TP-2	
	SG-7/350-LY47K	95	Karma	SS	350	6.3	3.9	12	7.8	15	TP-3	
	SG-13/1000-LY47K	99	Karma	SS	1000	13.0	5.0	23	10	17	TP-3	
	SG-2/350-LY47	45	Constantan	SS	350	2.0	2.5	7.8	6.0	5	TP-1	
	SG-3/350-LY47	45	Constantan	SS	350	3.8	1.7	7.0	6.0	10	TP-2	
	SG-7/350-LY47	79	Constantan	SS	350	7.0	3.5	14.0	8.0	15	TP-3	
	SG-13/350-LY47	85	Constantan	SS	350	12.5	5.0	23.0	10.0	17	TP-3	
		Pkg of 10										
	SG-2/350-LY41	45	Constantan	CS	350	2.0	2.5	7.8	6.0	5	TP-1	
	SG-3/350-LY41	45	Constantan	CS	350	3.8	1.7	8.3	4.6	10	TP-2	
	SG-7/350-LY41	65	Constantan	CS	350	7.0	3.5	14.0	8.0	15	TP-3	
	SG-13/350-LY41	115	Constantan	CS	350	12.5	5.0	23.0	10.0	17	TP-3	
	SG-2/350-LY43	45	Constantan	ALUM	350	2.0	2.5	7.8	6.0	5	TP-1	
	SG-3/350-LY43	45	Constantan	ALUM	350	3.8	1.7	8.3	4.6	10	TP-2	
	SG-7/350-LY43	65	Constantan	ALUM	350	7.0	3.5	14.0	8.0	15	TP-3	
SG-13/350-LY43	115	Constantan	ALUM	350	12.5	5.0	23.0	10.0	17	TP-3		

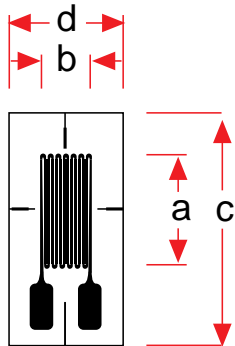

Dimensions

Diagram Shown Larger Than Actual Size

For Accessory Terminal Pads, see page E-25.

Ordering Example: SG-3/350-LY47K is a package of five uniaxial strain gages with Karma foil and encapsulated solder pads, \$89

* "SS" is a temperature coefficient matched to stainless steel. (LY47)

"CS" is a temperature coefficient matched to carbon steel. (LY41)

"ALUM" is a temperature coefficient matched to aluminum. (LY43)

To Order (Specify Model Number)

TYPE SERIES	MODEL NO.	PRICE PER PKG OF 5	FOIL MATERIAL	TEMP. COEF.*	Ω	DIMENSIONS [MM]				MAX EXC	TERM PADS
						GRID A	GRID B	CARRIER C	CARRIER D		
TY SERIES TORQUE GAGES ✓ Encapsulated Gages with Four Solder Pads (Accessory Terminal Pads Are Used for Strain Relief and Connecting Different Gage Wires)	SG-5/1000-TY47K	\$69	Karma	SS	1000	4.7	2.4	11.5	8.1	15	TP-2
	SG-6/1000-TY47K	45	Karma	SS	1000	5.7	3.8	11.5	8.6	15	TP-2
	SG-5/350-TY47	65	Constantan	SS	350	4.7	2.4	11.5	8.1	10	TP-2
	SG-6/350-TY47	35	Constantan	SS	350	5.7	3.8	11.5	8.6	10	TP-2
	SG-5/350-TY41	65	Constantan	CS	350	4.7	2.4	11.5	8.1	10	TP-2
	SG-6/350-TY41	35	Constantan	CS	350	5.7	3.8	11.5	8.6	10	TP-2
	SG-5/350-TY43	65	Constantan	ALUM	350	4.7	2.4	11.5	8.1	10	TP-2
	SG-6/350-TY43	35	Constantan	ALUM	350	5.7	3.8	11.5	8.6	10	TP-2

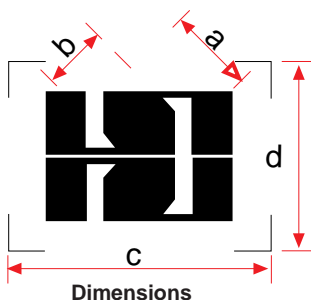

Dimensions

Diagram Shown Larger Than Actual Size

Ordering Example: SG-6/350-TY47 is a package of five torque gages with two Constantan grids, encapsulated with 4 solder pads, \$35.

* "SS" is a temperature coefficient matched to stainless steel. (TY47)

"CS" is a temperature coefficient matched to carbon steel. (TY41)

"ALUM" is a temperature coefficient matched to aluminum. (TY43)

For Accessory Terminal Pads, see page E-25.

Torsional Strain

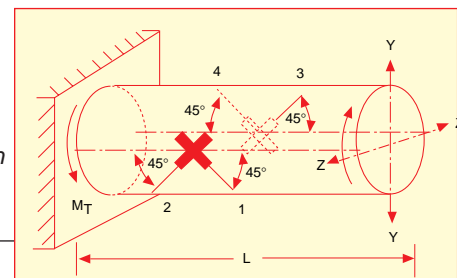

ROSETTE STRAIN GAGES

To Order (Specify Model Number)

TYPE SERIES	MODEL NO.	PRICE PER PKG OF 5	FOIL MATERIAL	TEMP. COEF.*	Ω	DIMENSIONS [MM]				MAX EXC	TERM PADS
						GRID		CARRIER			
						A	B	C	D		
Diagrams Shown Larger Than Actual Size	SG-4/1000-TY37K	\$49	Karma	SS	350	3.8	3.2	9.5	6.9	10	TP-2
	SG-4/350-TY37	45	Constantan	SS	350	3.8	3.2	9.5	6.9	10	TP-2
	SG-4/350-TY31	45	Constantan	CS	350	3.8	3.2	9.5	6.9	10	TP-2
	SG-4/350-TY33	45	Constantan	ALUM	350	3.8	3.2	9.5	6.9	10	TP-2

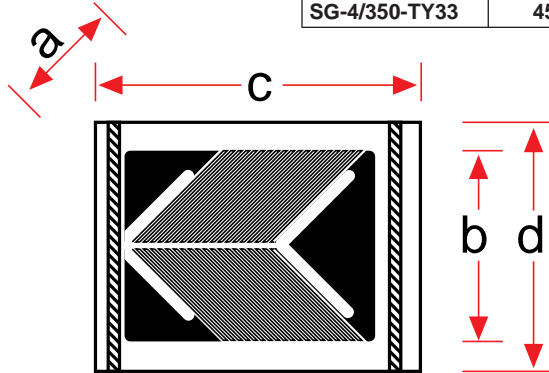

Dimensions

TY SERIES TORQUE GAGES

- ✓ Encapsulated Gages with Three Solder Pads (Accessory Terminal Pads Are Used for Strain Relief and Connecting Different Gage Wires)

Ordering Example: SG-4/1000-TY37K is a package of five torque gages with two Karma grids, encapsulated with three solder pads, \$49.
 * "SS" is a temperature coefficient matched to stainless steel. (TY37)
 "CS" is a temperature coefficient matched to carbon steel. (TY31)
 "ALUM" is a temperature coefficient matched to aluminum. (TY33)

For Accessory Terminal Pads, see page E-25.

To Order (Specify Model Number)

TYPE SERIES	MODEL NO.	PRICE PER PKG OF 5	FOIL MATERIAL	TEMP. COEF.*	Ω	DIMENSIONS [MM]				MAX EXC	TERM PADS
						GRID		CARRIER			
						A	B	C	D		
Diagram Shown Larger Than Actual Size	SG-3/350-XY47K	\$115	Karma	SS	350	3.0	2.8	8.0	8.0	10	TP-2
	SG-7/350-XY47K	149	Karma	SS	350	7.0	3.5	13.0	13.0	15	TP-3
	SG-3/350-XY47	109	Constantan	SS	350	3.0	2.8	8.0	8.0	10	TP-2
	SG-7/350-XY47	145	Constantan	SS	350	6.8	2.8	13.0	13.0	15	TP-3
	SG-3/350-XY41	105	Constantan	CS	350	3.0	2.8	8.0	8.0	10	TP-2
	SG-7/350-XY41	149	Constantan	CS	350	7.0	3.5	13.0	13.0	15	TP-3
	SG-3/350-XY43	105	Constantan	ALUM	350	3.0	2.8	8.0	8.0	10	TP-2
	SG-7/350-XY43	149	Constantan	ALUM	350	6.8	2.8	13.0	13.0	15	TP-3

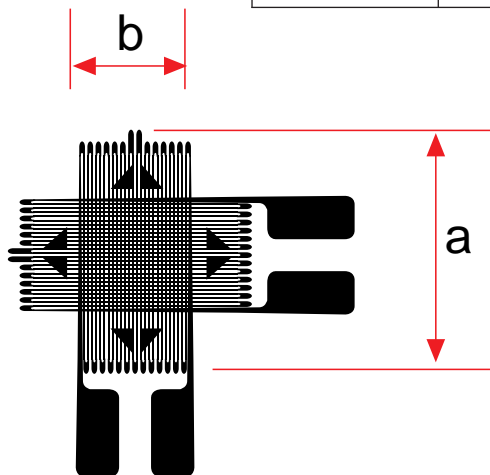

Dimensions

XY SERIES BIAxIAL GAGES FOR AXIAL STRAIN

- ✓ Encapsulated Gages with Solder Pads (Accessory Terminal Pads Are Used for Strain Relief and Connecting Different Gage Wires)

Ordering Example: SG-3/350-XY47K is a package of five biaxial gages with two Karma grids, encapsulated with solder pads, \$115.
 * "SS" is a temperature coefficient matched to stainless steel. (XY47)
 "CS" is a temperature coefficient matched to carbon steel. (XY41)
 "ALUM" is a temperature coefficient matched to aluminum. (XY43)

For Accessory Terminal Pads, see page E-25.



UNITED STATES

www.omega.com
1-800-TC-OMEGA
Stamford, CT.

CANADA

www.omega.ca
Laval(Quebec)
1-800-TC-OMEGA

GERMANY

www.omega.de
Deckenpfronn, Germany
0800-8266342

UNITED KINGDOM

www.omega.co.uk
Manchester, England
0800-488-488

FRANCE

www.omega.fr
Guyancourt, France
088-466-342

CZECH REPUBLIC

www.omegaeng.cz
Karviná, Czech Republic
596-311-899

BENELUX

www.omega.nl
Amstelveen, NL
0800-099-33-44



More than 100,000 Products Available!

• Temperature

Calibrators, Connectors, General Test and Measurement Instruments, Glass Bulb Thermometers, Handheld Instruments for Temperature Measurement, Ice Point References, Indicating Labels, Crayons, Cements and Lacquers, Infrared Temperature Measurement Instruments, Recorders Relative Humidity Measurement Instruments, RTD Probes, Elements and Assemblies, Temperature & Process Meters, Timers and Counters, Temperature and Process Controllers and Power Switching Devices, Thermistor Elements, Probes and Assemblies, Thermocouples Thermowells and Head and Well Assemblies, Transmitters, Wire

• Flow and Level

Air Velocity Indicators, Doppler Flowmeters, Level Measurement, Magnetic Flowmeters, Mass Flowmeters, Pitot Tubes, Pumps, Rotameters, Turbine and Paddle Wheel Flowmeters, Ultrasonic Flowmeters, Valves, Variable Area Flowmeters, Vortex Shedding Flowmeters

• pH and Conductivity

Conductivity Instrumentation, Dissolved Oxygen Instrumentation, Environmental Instrumentation, pH Electrodes and Instruments, Water and Soil Analysis Instrumentation

• Data Acquisition

Auto-Dialers and Alarm Monitoring Systems, Communication Products and Converters, Data Acquisition and Analysis Software, Data Loggers Plug-in Cards, Signal Conditioners, USB, RS232, RS485 and Parallel Port Data Acquisition Systems, Wireless Transmitters and Receivers

• Pressure, Strain and Force

Displacement Transducers, Dynamic Measurement Force Sensors, Instrumentation for Pressure and Strain Measurements, Load Cells, Pressure Gauges, Pressure Reference Section, Pressure Switches, Pressure Transducers, Proximity Transducers, Regulators, Strain Gages, Torque Transducers, Valves

• Heaters

Band Heaters, Cartridge Heaters, Circulation Heaters, Comfort Heaters, Controllers, Meters and Switching Devices, Flexible Heaters, General Test and Measurement Instruments, Heater Hook-up Wire, Heating Cable Systems, Immersion Heaters, Process Air and Duct, Heaters, Radiant Heaters, Strip Heaters, Tubular Heaters